



product name **lily rec**

SKU: WBLILR20

dimensions **20" x 14" x 3-1/2"**

available in 30+ colors

example installation

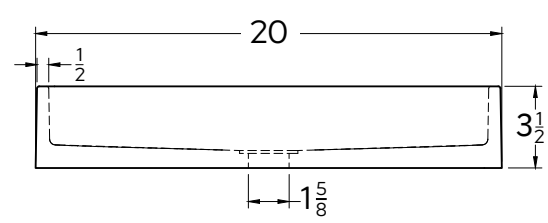
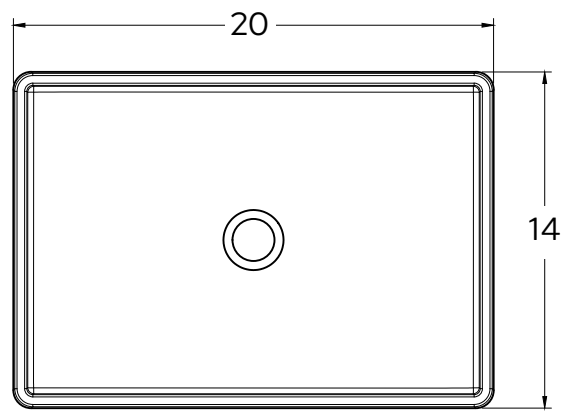
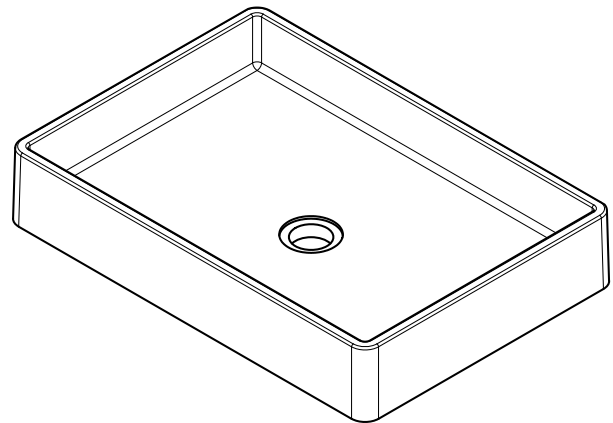
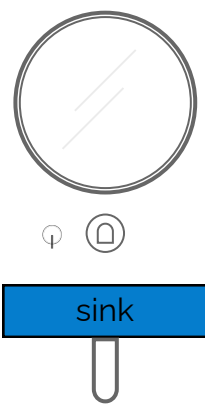

details MATERIAL: ultra high performance concrete  
WEIGHT: 26 lbs  
DIMENSIONS: 20" x 14" x 3-1/2"  
DRAIN: do not exceed 1-1/2" drain diameter  
WARRANTY: 1 year manufacturers warranty  
DRAIN HOLE: 1-5/8"  
WALL THICKNESS: 1/2"  
OPTIONS: surface mount / wall mount / stand  
WALL HANG: mount before tiling - to timber frame or masonry wall.